

ROAD DESIGN PRESENTATION STANDARDS

DP014 - LONG SECTION

K Net Number: 13555464
Document Revision: 3
Document Date: 23 November 2011

DEPARTMENT OF
PLANNING, TRANSPORT
AND INFRASTRUCTURE



Government of South Australia
Department of Planning,
Transport and Infrastructure

Document Amendment Record

Rev	Change Description	Date	Author	Checked	Authorised
1	Initial Issue	29 July 2009	Anthony Crotty	Natasha Stone	Noel O'Callaghan
2	General review of text and example drawings	17 March 2010	John Hastie Alison Freer		Noel O'Callaghan
3	General review of text and example drawings	23 November 2011	Natasha Stone Alison Freer		Noel O'Callaghan

Document Management

This document is the Property of the Department of Planning Transport and Infrastructure (DPTI) and contains information that is confidential to DPTI. It must not be copied or reproduced in any way without the written consent of DPTI. This is a controlled document and it will be updated and reissued as approved changes are made.

To be read in conjunction with CAD Manual & Presentation Guidelines DP001
(Master Specification PC-EDM7)

DP014 LONG SECTION

1 Purpose

- 1.1 The 'Longitudinal Section' drawing is used to show the vertical relationship between the designed and existing surfaces. The drawing is also used to show the geometric details of the reference string involved.
- 1.2 For examples of this standard see attached drawings.
- 1.3 The details listed below can be arranged on the General Construction drawing provided they do not cause the drawing to become congested.

2 Content

- 2.1 Layers to be shown as per the DPTI Layer Matrix (DP001)
- 2.2 The following CAD entities are required:
 - a) All information in DP 001 - General Requirements.
- 2.3 Lines shall be shown indicating the following:
 - a) Existing & design surfaces.
 - b) Reference string.
 - c) Other surfaces or design strings may be shown at the discretion of the designer
 - d) Datum level.
 - e) Ordinates
 - f) Grades between vertical intersection points.
 - g) Line and Text indicating the Datum Level.
 - h) Symbols showing high and low-point locations
- 2.4 Text shall be shown identifying the following:
 - a) Existing surface & design surface levels.
 - b) Reference string level.
 - c) Reference string vertical & horizontal geometry.
 - d) Levels of other surfaces or design strings shown at the discretion of the designer
 - e) Super-elevation applications.
 - f) Datum level
 - g) Chainage and level of vertical intersection points.
 - h) Chainage and level of high and low points
 - i) Chainages.

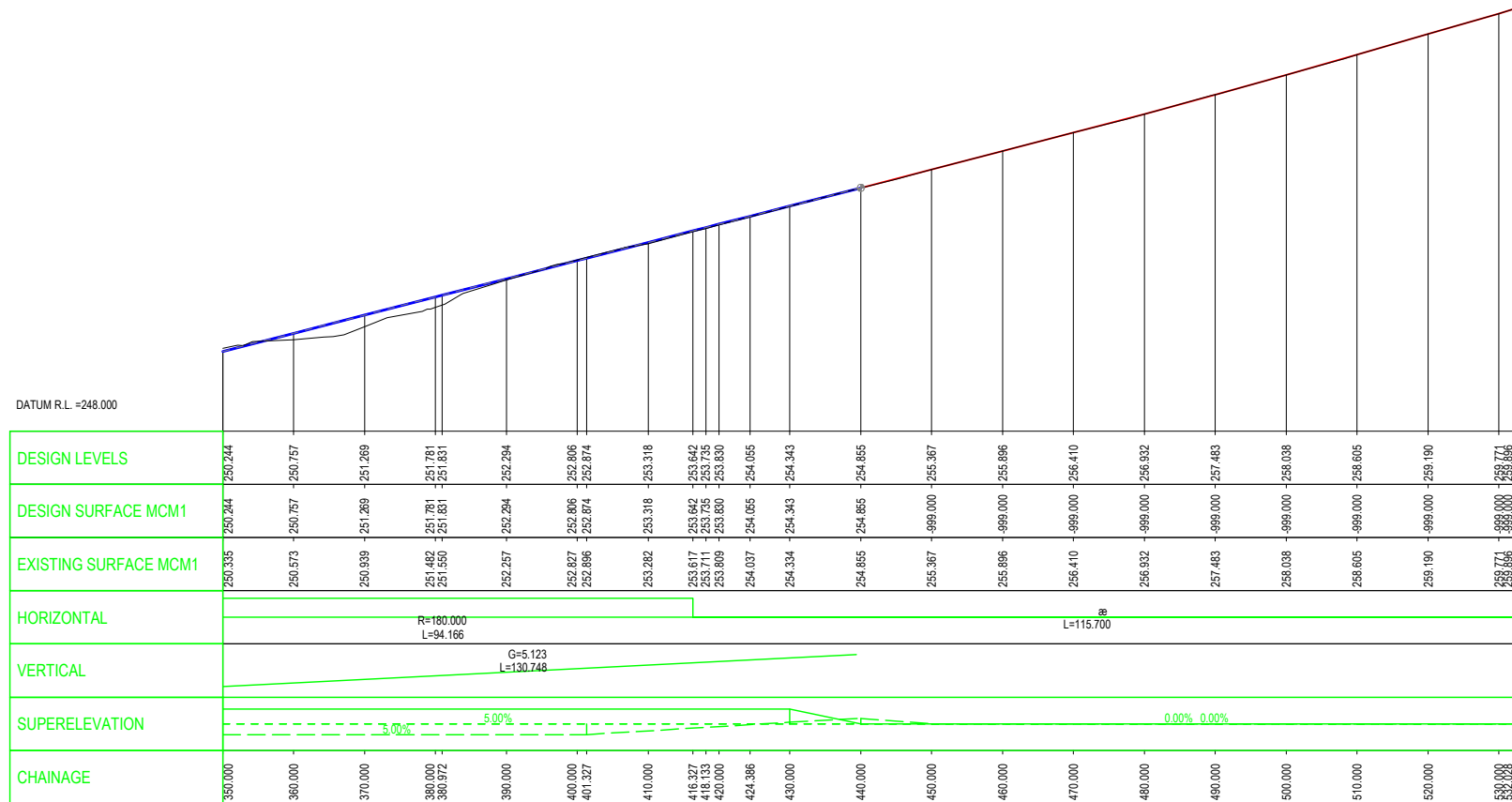
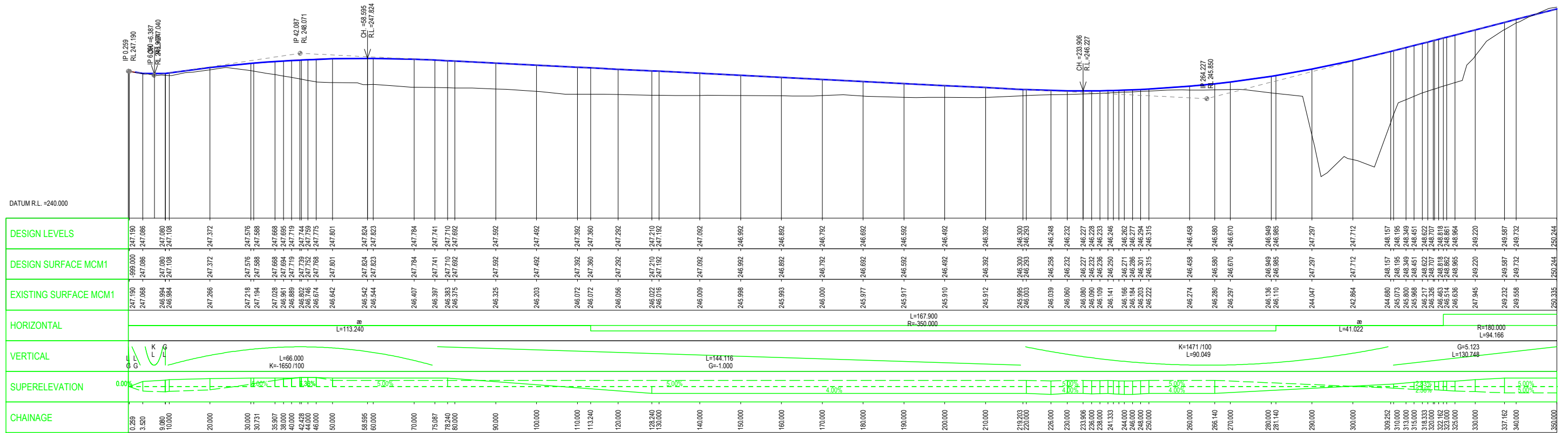

1	GENERAL REVIEW OF DRAWING	AEF	NKS	J.LANE	23.12.11
No.	AMENDMENT DESCRIPTION	BY	CHECK	ACCEPTANCE	DATE

100 MILLIMETRES ON ORIGINAL DRAWING

ALL DIMENSIONS ARE IN METRES UNLESS SHOWN OTHERWISE

Government of South Australia
Department of Planning, Transport and Infrastructure

PROJECT No.: 14669
FILE No.: 07/04422

DESIGN No.: 20070652
SURVEY No.: 20070774

PROJECT START ROAD RUNNING DISTANCE:
MCA1; CH 0000 = 54.89 km

PROJECT END ROAD RUNNING DISTANCE:
MCA1; CH 4560 = 59.45 km

SCALES:
H 10 0 5 10 15 20
V 2 0 1 2 3 4

DESIGNED: ANC
CHECKED: DSNE

DRAFTED: AEF
CHECKED: NKS

ACCEPTED FOR USE: A.SMITH
TITLE: MANAGER
DATE: 30/02/2010

ROAD No. 7200 STURT HIGHWAY
SEPPELTSFIELD ROAD - GREENOCK ROAD
MCA1; CH 000 - CH 532.08
ROAD LONGITUDINAL SECTIONS

ACCEPTANCE FORM KNET No.: 12345678
DRAWING No.: 5933
SHEET No.: 765
AMEND No.: 1

IN ACCORDANCE WITH DP013
UNCONTROLLED COPY WHEN PRINTED