



South Eastern Freeway Pavement Rehabilitation – Tollgate to Heysen Tunnels

Access to City Bound Mount Osmond Ramps

Further to our recent notification regarding Stage Two South Eastern Freeway pavement rehabilitation works, the **city bound Mount Osmond on-ramp and city bound Mount Osmond off-ramp will remain closed during the day until approximately late March 2021, weather permitting**

The ramps were initially scheduled to be closed during the day from 2 - 15 March, 2021. The short extension is required due to recent inclement weather. The ramps will continue to remain closed at night.

Off-ramp: Vehicles will need to continue travelling city bound on the freeway, turn right onto Portrush Road, right onto Gilles Road, left onto Sunnyside Road, right onto Thirkell Terrace and then continue onto Hayward Drive and Mount Osmond Road.

On-ramp: Vehicles will need to detour via the uphill Mount Osmond Road on-ramp and then take the Mount Barker Road off-ramp, use the overpass and then re-enter the freeway city bound via the Mount Barker Road on-ramp.

In addition to these works, the Department will be undertaking works on the Mt Osmond Road Bridge over the South Eastern Freeway to install variable speed limit signage. **These works will be undertaken at night on Saturday, 20 March and the following Saturday, 27 March, between the hours of 5pm and 10am, weather permitting.**

Night works are being undertaken to minimise traffic impacts during the day and complete the works as quickly and safely as possible. The Department will make every effort to minimise noise and disruption during this period.

Speed and lane restrictions will be in place during the works. Road users are advised to use extra caution when workers are on site, follow the directions of traffic controllers and observe traffic signage and speed restrictions when travelling through the area.

Please be advised that stage two works (please see map overleaf) will now continue through until approximately April 2021, weather permitting. All other details outlined in the previously issued Stage 2 notification remain unchanged.

dit.sa.gov.au

Follow us on:



Australian Government

BUILDING OUR FUTURE



Government
of South Australia



**BUILDING
WHAT MATTERS**

Further information

For details of upcoming works see the SA Infrastructure and Transport Facebook page. For more information on the project, or to register for project updates, please contact the project team via the details below:

- visit: www.dit.sa.gov.au/SEFreeway
- email: dit.communityrelations@sa.gov.au
- telephone: 1300 103 456
- SitePodium: stay up to date with the project via the SitePodium app, visit www.dit.sa.gov.au/SEFreeway for details on how to download the app.

The Department appreciates your patience and cooperation while these important works are undertaken.

Kind regards

South Eastern Freeway Pavement Rehabilitation Project Team



Stage 2 Heysen Tunnels to Tollgate, city bound lanes: Day time traffic restrictions
 Tuesday 2 March – Early April (weather permitting)

Day time traffic restrictions (weather permitting)
 Monday to Friday: 6am - 7pm
 Weekends: 8am Saturday - 7pm Sunday

Speed Restrictions
 For city bound lanes, speed restrictions of 60kph will commence from approximately the Measdays Bridge, to allow heavy vehicles and light vehicles to be travelling at the same speed prior to any lane closure. This reduces the likelihood of collisions and reduces the severity if a collision was to occur. Speed restrictions will be in place for uphill traffic adjacent the work zone. Outside of this, speeds for uphill traffic will not be affected.

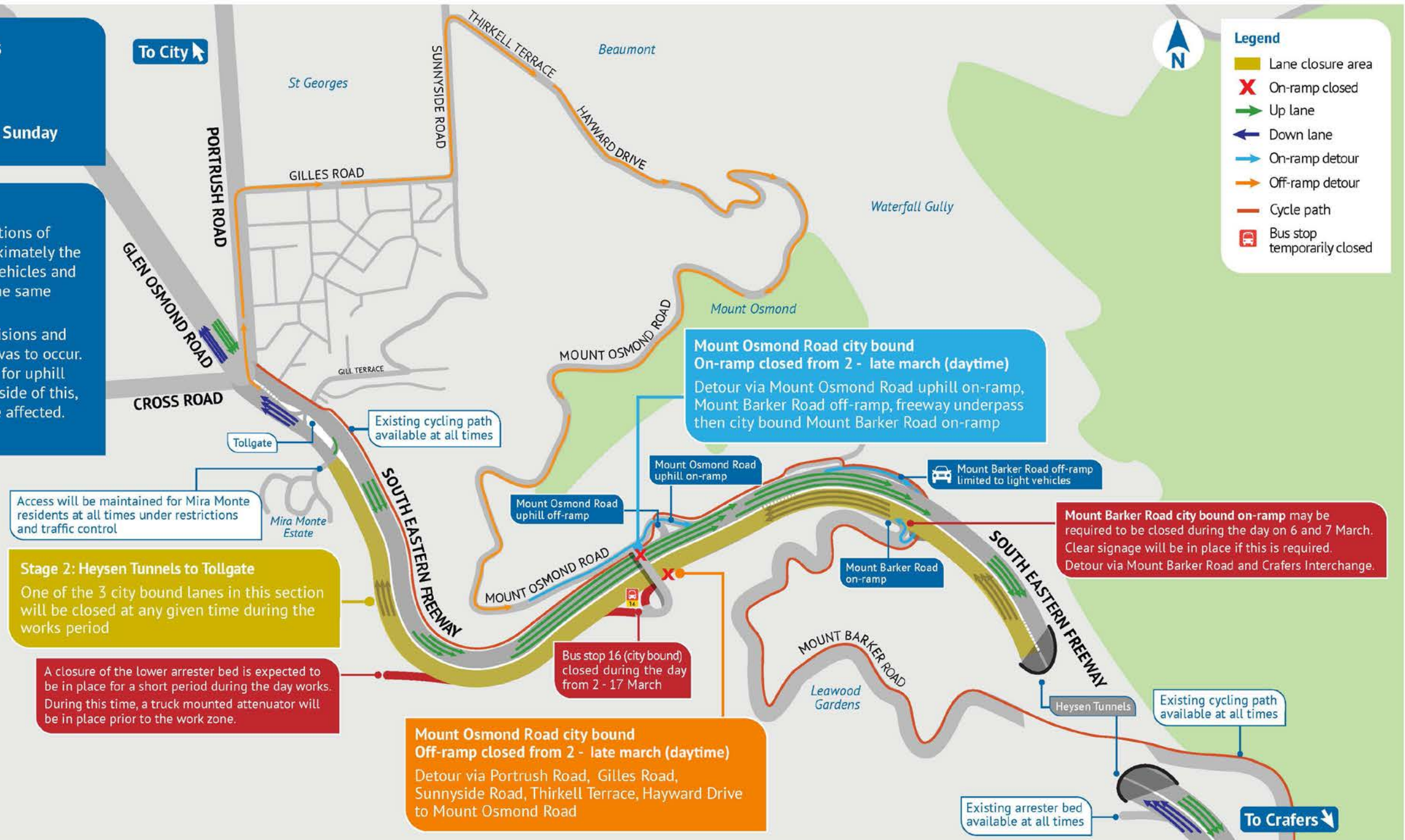

www.dit.sa.gov.au/SEFreeway
 1300 103 456

Follow us on:





Stage 2 Heysen Tunnels to Tollgate, city bound lanes: Night works traffic restrictions

Tuesday 2 March – Early April (weather permitting)

Night works schedule (weather permitting)

7pm - 6am, Monday - Friday
7pm Friday - 8am Saturday
5pm Sunday - 6am Monday

Speed Restrictions

Speeds for downhill light vehicle traffic will be restricted to 40kph from Measdays Bridge and then 25kph from the Mount Osmond Interchange to the Portrush Road intersection.

Speeds for uphill traffic will be restricted to 40kph through the work zone and will then return to the posted speed outside of this location.

Speeds for heavy vehicles will be restricted to 40kph from the Crafers Interchange and then 25kph from the Mount Osmond Interchange to the Portrush Road intersection.

Thank you for your patience, drive safely.

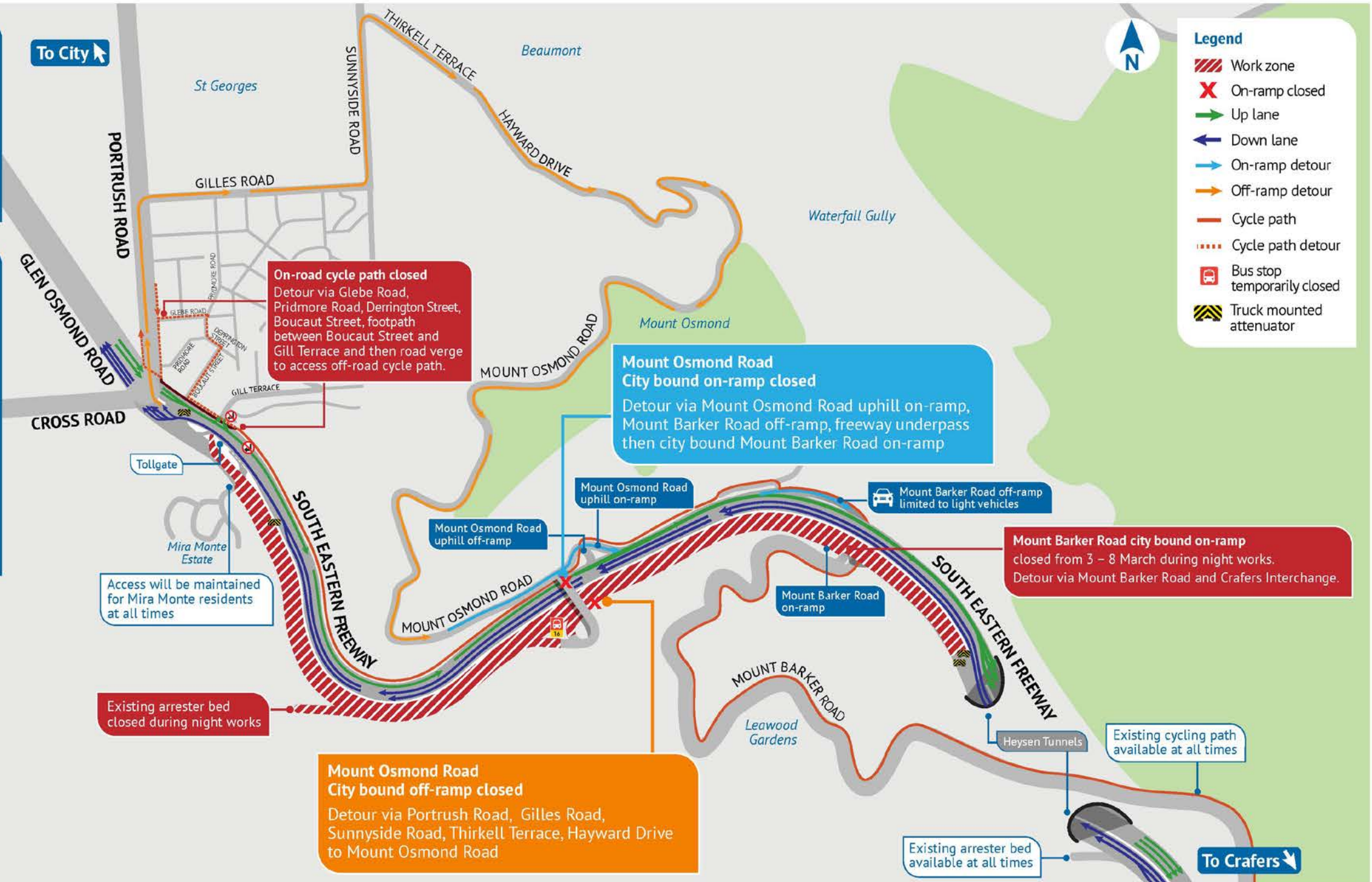

www.dit.sa.gov.au/SEFreeway

1300 103 456

Follow us on:



Australian Government

BUILDING OUR FUTURE



Government of South Australia



BUILDING WHAT MATTERS