

# Portrush and Magill Roads Intersection Upgrade

## Night Works

The Department for Infrastructure and Transport (the Department) is upgrading the intersection of Portrush and Magill roads to improve travel times, connectivity, capacity and safety for all users. The \$98 million project is jointly funded (50:50) by the Australian and South Australian governments.

Works recommenced in early January to construct new kerb and median islands and to install new road lighting, signal and stormwater infrastructure in preparation for the final stage of asphalt and line marking.

The final stage of asphalt works and line marking at the intersection, and on all approaches to the intersection, are expected to commence **Sunday, 30 January 2022**. These asphalt works will take approximately three weeks to complete, weather permitting.

**Hours of work are between 7pm and 6am, Sunday to Friday. No works will be undertaken on Saturday nights.**

### Planned traffic arrangements at night during the work:

- access along Portrush Road will be maintained in both directions via contraflow traffic control arrangements;
- there will be no access to Portrush Road from Magill Road (west of the intersection only) between **Sunday, 6 February 2022** and **Tuesday, 8 February 2022**; and
- there will be no access to Portrush Road from Magill Road (east of the intersection only) between **Wednesday, 9 February 2022** and **Friday, 11 February 2022**.

Please see maps over page for detour information. Please also check signage on site.

While most infrastructure works are being undertaken during the day, intermittent night works to complete medians and line marking will continue through February to minimise the impact to road users and to ensure the works can be completed safely and efficiently.

Some noise disturbance can be expected at times while these works are completed. You may also notice some odour which is common when asphaltting works are underway. Every effort will be made to minimise disruption to surrounding properties and road users, as much as practically possible.

To safely facilitate these works, changed traffic conditions including speed and lane restrictions will be in place. Please plan ahead, allow extra travel time and take extra care when workers are on site. Observe speed limits, lane restrictions and traffic controllers when travelling through the area.

Pedestrians and cyclists are advised to take care when travelling through the area. For safety reasons the footpath and bike lane on the western side of Portrush Road will remain closed between Beulah Road and Dover Street. Signage will be in place to direct pedestrians and cyclists to alternative access and/or detours.

[dit.sa.gov.au](http://dit.sa.gov.au)

Follow us on:    



Australian Government

**BUILDING OUR FUTURE**



Government  
of South Australia

Department for Infrastructure  
and Transport

Access to properties will be maintained throughout the works wherever possible, with advance notice provided if there is a need to temporarily restrict driveway access.

Public transport services will be detoured as required with advance notice of any temporary changes provided at the bus stops and on the Adelaide Metro website [www.adelaidemetro.com.au](http://www.adelaidemetro.com.au)

Every effort will be made to minimise the impact to the community. The Department appreciates your patience and cooperation whilst these important works are undertaken. If you have any questions or would like to speak to a member of the project team, please call 1300 595 263 or email [dit.communityrelations@sa.gov.au](mailto:dit.communityrelations@sa.gov.au)

Kind regards

Portrush and Magill Roads Intersection Upgrade Project Team

### Detour information

At night between Sunday, 6 February and Tuesday, 8 February 2022, weather permitting.

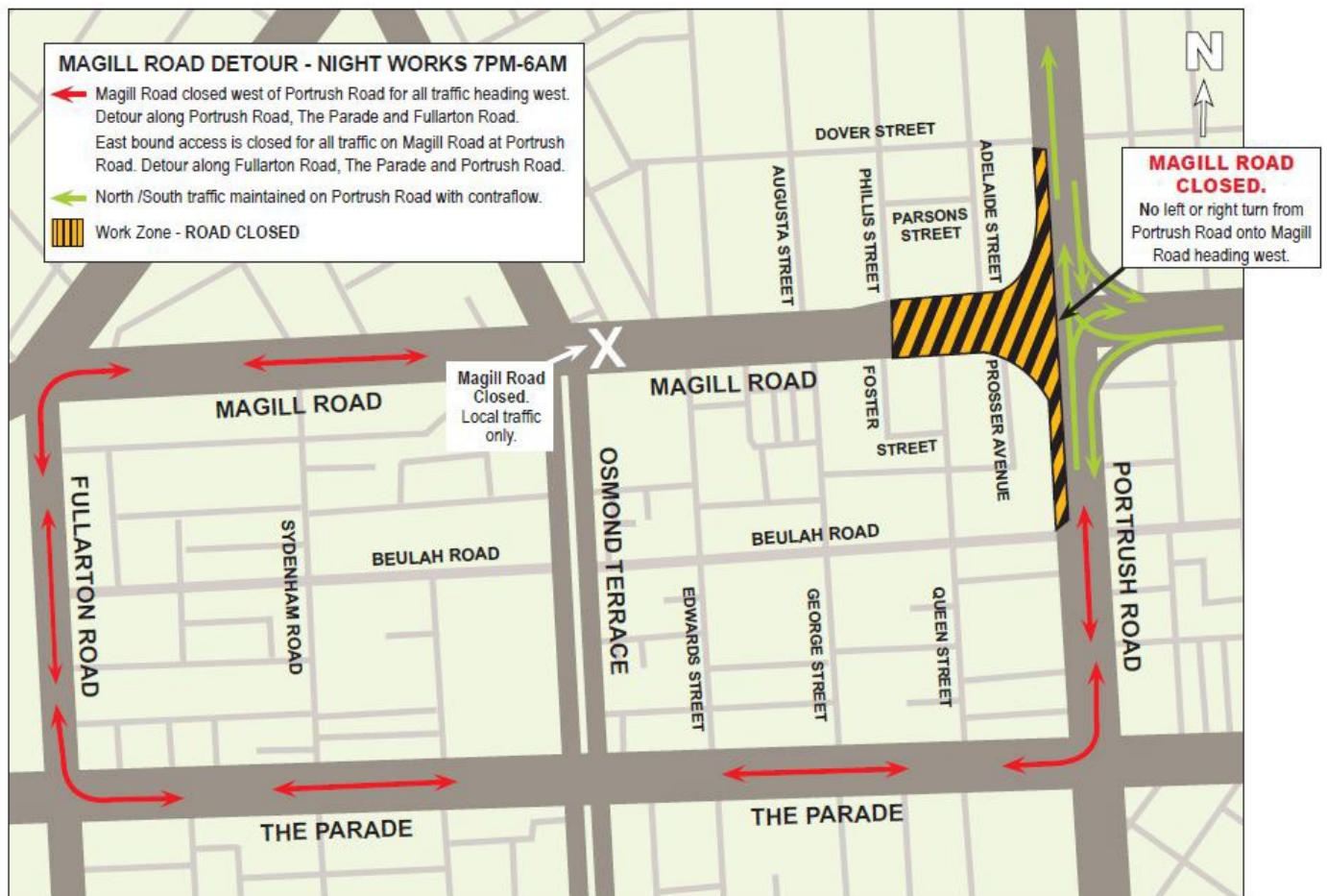

At night between Wednesday, 9 February and Friday, 11 February 2022, weather permitting.

