

Darlington Upgrade Project

Sturt Road changed traffic arrangements

Weekend 20-23 March

As part of the Darlington Upgrade Project, changed traffic arrangements will be in place for asphaltting works to be undertaken on the westbound carriageway of Sturt Road between Laffer Drive and Warriparinga Way.

8pm Friday, 20 March until 6am Monday, 23 March

The **westbound carriageway of Sturt Road, between Laffer Drive and Warriparinga Way**, will be temporarily closed with the following traffic arrangements in place **as per the map overleaf**:

- Westbound vehicles will be detoured onto the eastbound carriageway of Sturt Road (see map overleaf for details).
- Bradley Grove, Birch Crescent and McInerney Avenue will remain open, with left in / left out movements only.
- The Sturt Police Station carpark access will be closed. Visitors to the Sturt Police Station will need to park in the Construction office car park accessible via Laffer Drive and then walk in the flagged pedestrian access path to reach the Sturt Police Station (see map overleaf for details).
- Bus Stop 29 on Sturt Road westbound will be temporarily closed for these works. For further information regarding changes to bus stops, detours and timetables please visit www.adelaidemetro.com.au

Access for emergency service vehicles, cyclists and pedestrians will be maintained at all times during these works.

Some noise disturbance can be expected at times while these works are completed, however the work will be managed to minimise disturbance to local residents and businesses as much as practically possible.

Please plan ahead, allow extra travel time and take extra care when workers are on site. Observe speed limits, lane restrictions and traffic controllers when travelling through the area.

If you have any questions or would like to speak to a member of the project team, please call 1300 759 334 or email: enquiries@gatewaysouth.com.au

Kind Regards,
Darlington Upgrade Project Team

20 March 2020

Sturt Road traffic restrictions

8pm Friday 20 March until 6am Monday 23 March

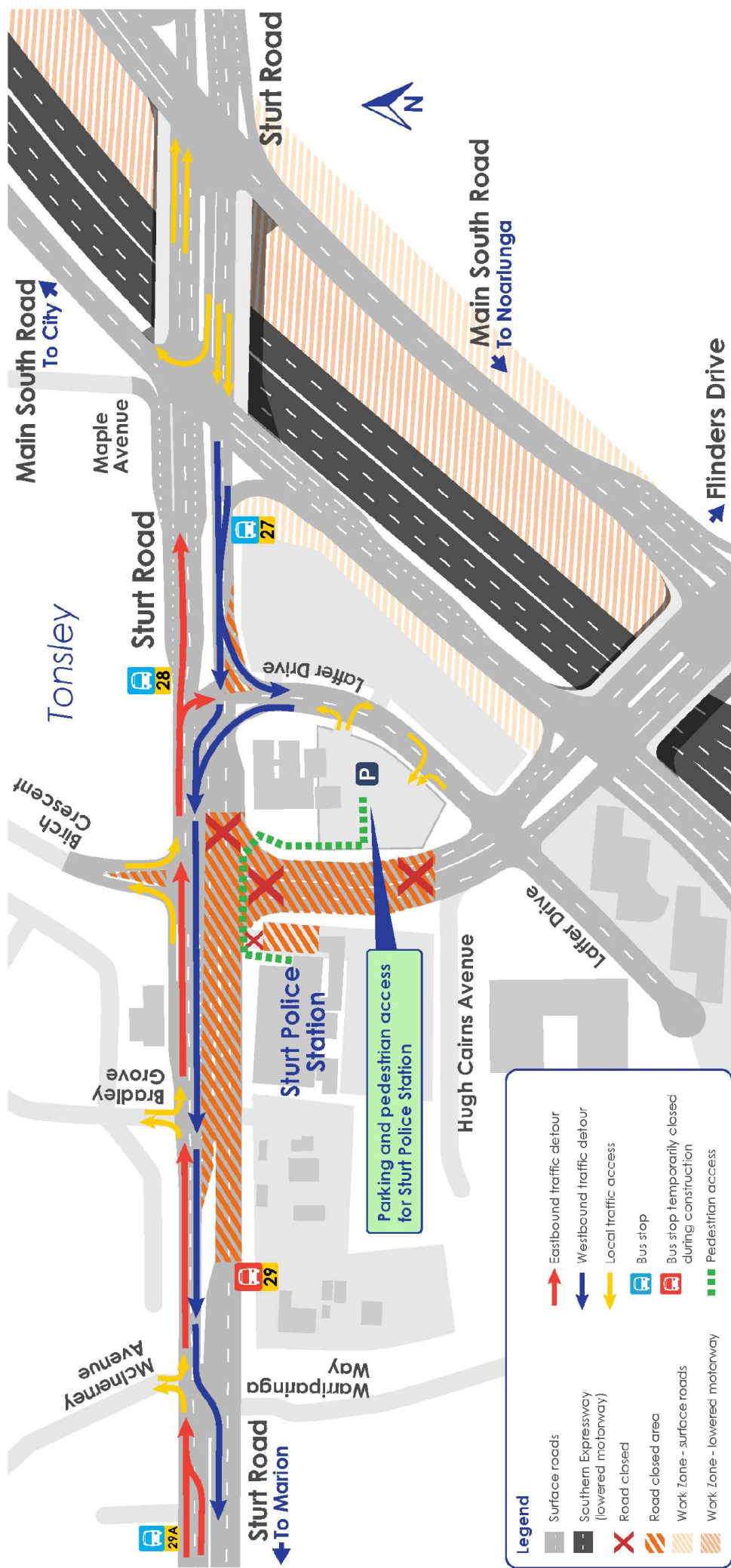

Legend

- Surface roads
- Southern Expressway (lowered motorway)
- Road closed
- Road closed area
- Work Zone - surface roads
- Work Zone - lowered motorway
- Eastbound traffic detour
- Westbound traffic detour
- Local traffic access
- Bus stop
- Bus stop temporarily closed during construction
- Pedestrian access