

North-South Corridor

Northern Connector Project

South Road Superway night works – off-ramp closure and detour

As part of the Northern Connector Project, the South Road Superway off-ramp to Salisbury Highway will be closed for two nights.

Work hours:

- 5pm Sunday 13 October, until 5am Monday 14 October, and
- 7pm Monday 14 October, until 5am Tuesday 15 October, weather permitting.

Activities: New line marking, and relocation and installation of safety barriers.

Traffic management: Access to the Salisbury Highway will be maintained via a detour to the Hanson Road interchange (refer to map).

Speed and lane restrictions will apply in the vicinity of the works, including the South Road Superway. Signage and traffic management will be in place to advise motorists of changed conditions.

Thank you for your patience while these important works are undertaken.

More information: To sign up for traffic updates, please contact the Project Information Line on 1300 916 221 or email your contact details to northernconnector@lendlease.com.

For real time roadwork information visit www.addinsight.com.au and download the app, available for both Apple and Android, or visit the Traffic SA website at www.traffic.sa.gov.au.

Follow www.facebook.com/DPTISA for regular project updates.

#14561743

For further information:

Call: 1300 916 221

Email: northernconnector@lendlease.com

Visit: dpti.sa.gov.au/northernconnector



Government of South Australia

Department of Planning,
Transport and Infrastructure

Detour for South Road Superway night works

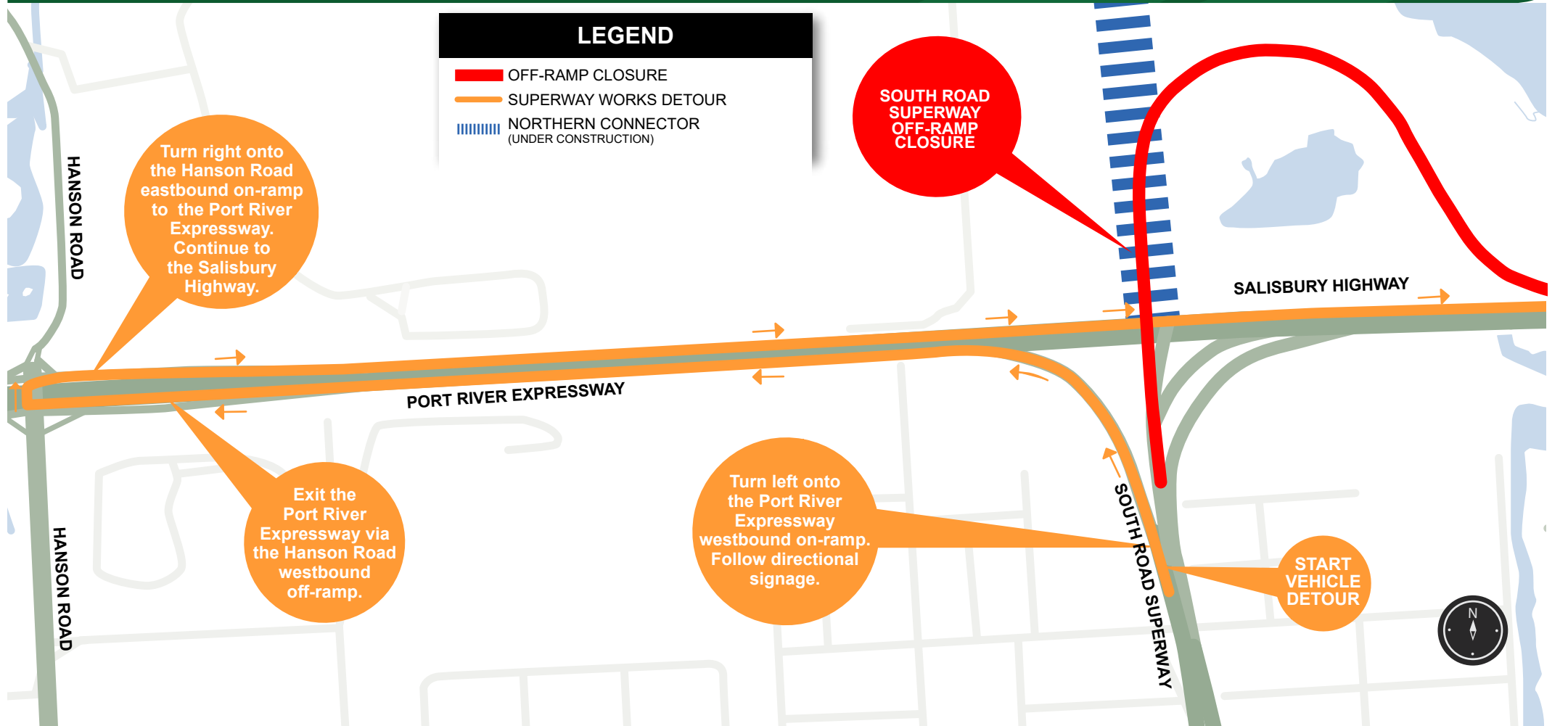

For further information
Visit: dpti.sa.gov.au/northernconnector
Email: northernconnector@lendlease.com
Call: 1300 916 221