



Gawler Rail Electrification Project

Cormack Road level crossing temporary closure

As part of the Gawler Rail Electrification Project, the Cormack Road level crossing will be temporarily closed to complete overhead wiring works.

Location: works will be undertaken within the rail corridor between Kilburn and Dry Creek railway stations, with **the temporary closure of the Cormack Road level crossing.**

When: works will be undertaken at night to minimise impact to traffic during peak times, with the crossing closed at the following times:

- Saturday, 15 May 9pm to 5am Sunday, 16 May 2021
- Sunday, 16 May 9pm to 5am Monday, 17 May 2021
- Tuesday, 25 May 9pm to 5am Wednesday, 26 May 2021

Traffic management and detours: the level crossing will be **closed to all traffic** when works are occurring. Detours will be in place to direct motorists to alternative crossing points via Grand Junction Road (refer to map). Speed restrictions will also apply. Please observe signage, speed restrictions and traffic controllers.

Access to residential properties and businesses will be maintained at all times. Pedestrians will be assisted to cross by staff on site (if safe to do so) or directed to the nearest safe crossing point.

Please plan ahead, allow extra time and take care when travelling through the area.

dit.sa.gov.au

Follow us on:    



Australian Government

BUILDING OUR FUTURE



Government
of South Australia



**BUILDING
WHAT MATTERS**

What you can expect: construction plant and equipment including wiring trucks, elevated working platforms and other construction vehicles will be used on site. As work crews move along the railway line, some noise can be expected from construction machinery. Every effort will be made to minimise disruption to residents and businesses during these works as much as is practically possible.

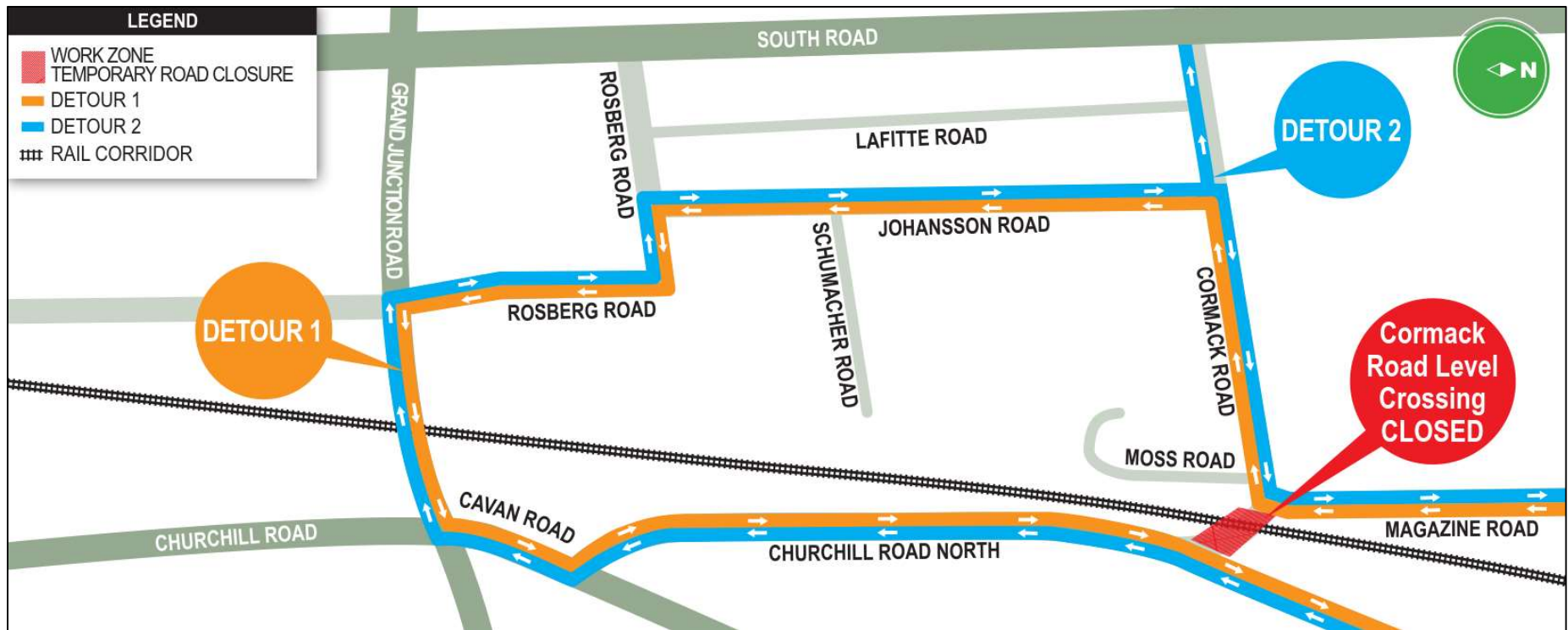

For more information, please call 1300 080 834, email dit.gawlerelectrification@sa.gov.au or visit www.dit.sa.gov.au/grep.

Follow www.facebook.com/DFITSA/ for project updates, or register your details to receive project updates directly by visiting www.dit.sa.gov.au/grep and selecting *Registration, Feedback and Suggestions*.

Kind regards

Gawler Rail Electrification Project Team

#17069448