

# Glen Osmond Road and Fullarton Road Intersection Upgrade

## Temporary closures of local roads and nightworks

The Australian and South Australian Governments have jointly funded (50:50) \$35 million to upgrade the Glen Osmond Road and Fullarton Road intersection. Once complete, the upgrade will improve travel times and road safety, increase intersection capacity and enhance network reliability.

As part of this project, the final layer of asphalt will soon be placed throughout the intersection. To safely undertake this work we need to temporarily close a series of local roads adjacent to the intersection.

To minimise impact to road users, these works will be undertaken at night.

### What to expect

Details of the closures are outlined below:

- **Main Street will be temporarily closed at Fullarton Road** from 7pm, Tuesday, 12 September until 6am Wednesday, 13 September 2023, weather permitting. Vehicles will be required to detour via Elizabeth Street and Matilda Street or Markey Street and Glen Osmond Road.
- **Main Avenue will be temporarily closed at Glen Osmond Road** from 7pm, Monday, 18 September until 6am Tuesday, 19 September 2023, weather permitting. Vehicles will be required to detour via Glen Osmond Road, Frederick Street and Avenue Road.
- **Hone Street will be temporarily closed at Fullarton Road** from 7pm, Thursday, 14 September until 6am Friday, 15 September 2023, weather permitting. Vehicles will be required to detour via Birks Street and Myra Street.
- **Campbell Road will be temporarily closed at Fullarton Road** from 7pm, Sunday, 17 September until 6am Monday, 18 September 2023, weather permitting. Vehicles will be required to detour via Birks Street and Myra Street.
- **Gladstone Street will be temporarily closed at Fullarton Road** from 7pm, Wednesday, 13 September until 6am Thursday, 14 September 2023, weather permitting. To maintain access for local residents, a traffic controller will be positioned at the junction of Glen Osmond Road and Gladstone Street to facilitate entry and exit.

Please refer to the map overleaf for detour details. Please follow local detour signage and traffic controller instructions. Observe speed limits, lane restrictions and traffic controllers when travelling through the area.

There may be some impacts to access private property driveways within the work zone. The project team will contact any affected property owners directly.

Some noise disturbances can be expected at times while these works are completed, however, the work will be managed to minimise disturbance to nearby residents as much as practically possible. You may also notice some odour which is common when asphalt works are underway. We appreciate your patience and cooperation whilst these important works are undertaken.

### Further information

For more information, or to register for project updates please contact the project team via phone on 1800 271 168, by email [DIT.GlenOsmondFullarton@sa.gov.au](mailto:DIT.GlenOsmondFullarton@sa.gov.au) or by visiting [www.dit.sa.gov.au/glenosmond](http://www.dit.sa.gov.au/glenosmond)

Kind regards

**Glen Osmond Road and Fullarton Road Intersection Upgrade Project engagement team**

[dit.sa.gov.au](http://dit.sa.gov.au)

Follow us on:    



**Australian Government**



**Government  
of South Australia**

Department for Infrastructure  
and Transport

### Temporary Road Closure – Main Street, Eastwood

7pm, Tuesday, 12 September until 6am Wednesday, 13 September 2023, weather permitting.

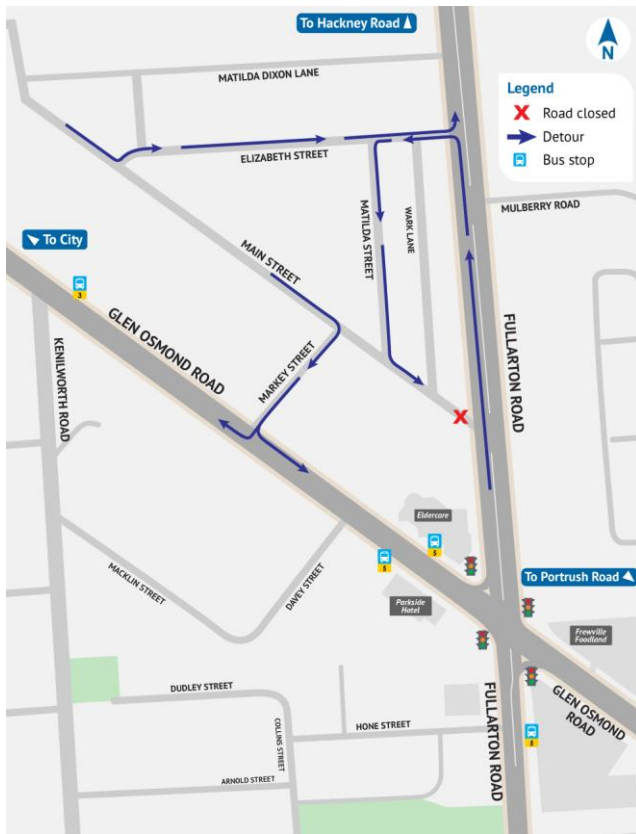

### Temporary Road Closure – Main Avenue & Chessington Avenue, Frewville

7pm, Monday, 18 September until 6am on Tuesday, 19 September 2023, weather permitting.

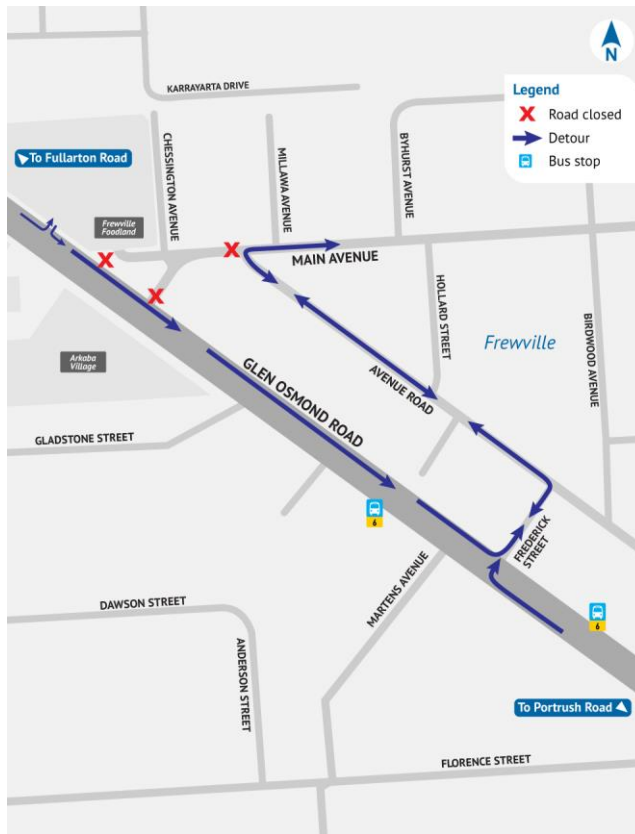

### Temporary Road Closures – Hone Street and Campbell Road, Parkside

Hone Street: 7pm, Thursday, 14 September until 6am, Friday 15 September 2023, weather permitting.

Campbell Road: 7pm, Sunday, 17 September until 6am Monday, 18 September 2023, weather permitting.

