

# North-South Corridor

## Northern Connector Project

### South Road Superway night works – off-ramp closure and detour

As part of the Northern Connector Project, the South Road Superway off-ramp to the Salisbury Highway will be closed for two nights.

**Work hours:** Monday 9 and Tuesday 10 September, between 8pm and 5am, weather permitting.

**Activities:** Relocation and installation of safety barriers.

**Traffic management:** Access to the Salisbury Highway will be maintained via a detour to Hanson Road (refer to map).

Speed and lane restrictions will apply in the vicinity of the works, including the South Road Superway. Signage and traffic management will be in place to advise motorists of changed conditions.

Thank you for your patience while these important works are undertaken.

**More information:** To sign up for traffic updates, please contact the Project Information Line on 1300 916 221 or email your contact details to [northernconnector@lendlease.com](mailto:northernconnector@lendlease.com).

For real time roadwork information visit [www.addinsight.com.au](http://www.addinsight.com.au) and download the app, available for both Apple and Android, or visit the Traffic SA website at [www.traffic.sa.gov.au](http://www.traffic.sa.gov.au).

Follow [www.facebook.com/DPTISA](https://www.facebook.com/DPTISA) for regular project updates.

#14437931

**For further information:**

Call: 1300 916 221

Email: [northernconnector@lendlease.com](mailto:northernconnector@lendlease.com)

Visit: [dpti.sa.gov.au/northernconnector](http://dpti.sa.gov.au/northernconnector)



Government of South Australia

Department of Planning,  
Transport and Infrastructure

# Detour for South Road Superway night works

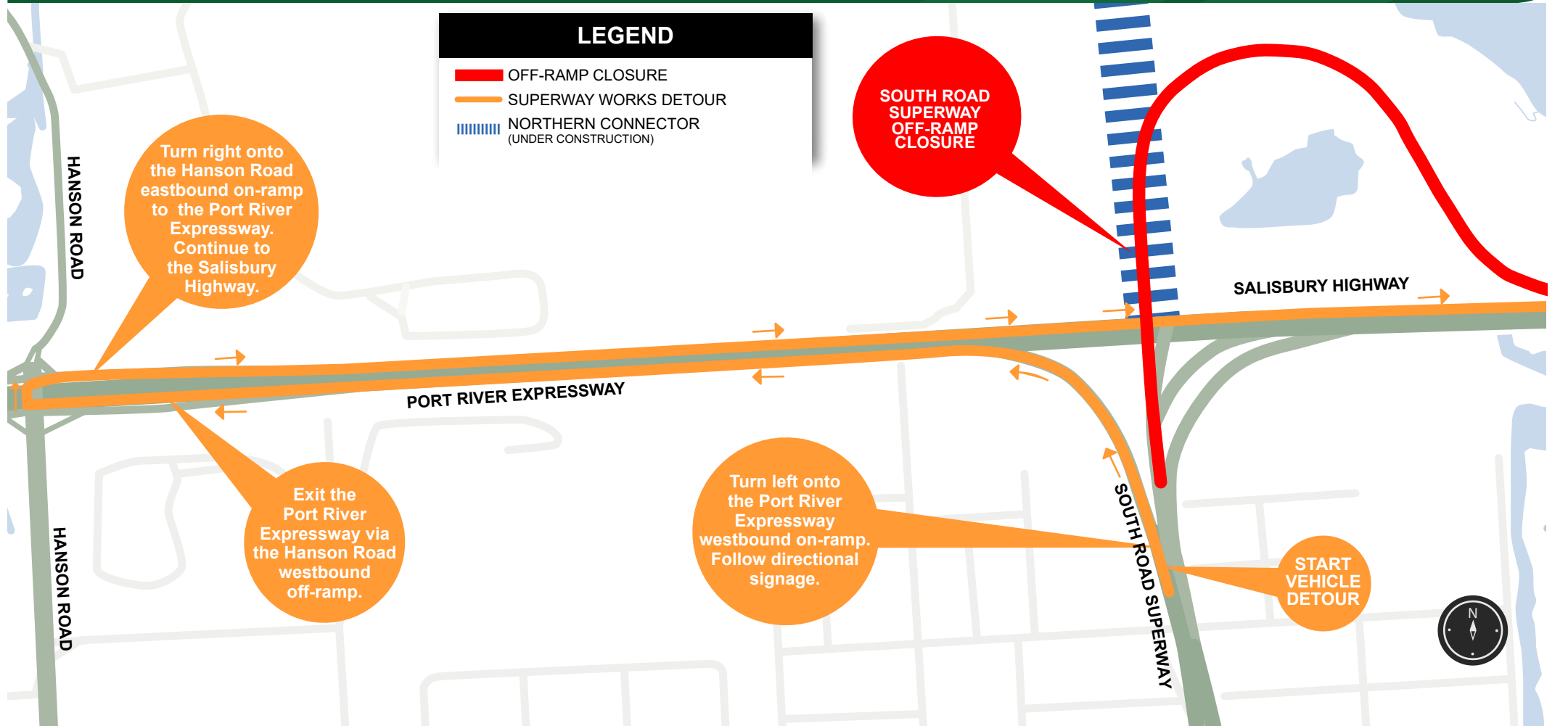

For further information  
Visit: [dpti.sa.gov.au/northernconnector](http://dpti.sa.gov.au/northernconnector)  
Email: [northernconnector@lendlease.com](mailto:northernconnector@lendlease.com)  
Call: 1300 916 221