

ABRAHAM BLOCKOUT NEARSIDE

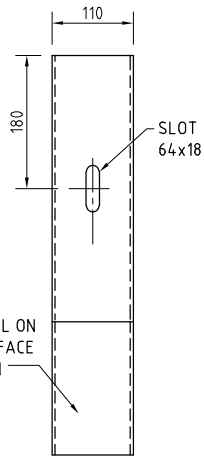

VIEW 4 SCALE 1:5

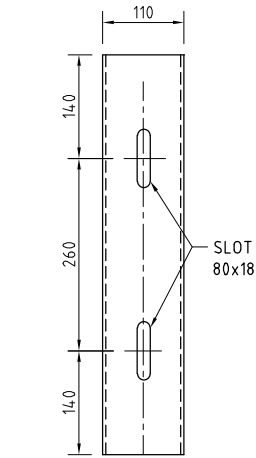

RISE 60-120 (NS-P016, OS-P017)

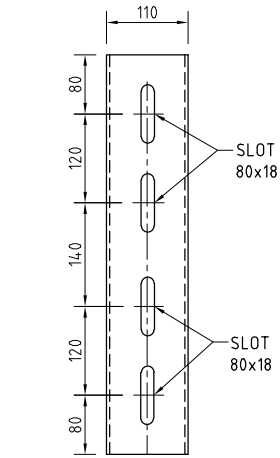

COMBINATION RISE 0-60 & 120-180 (NS-P018, OS-P019)

VIEW 5 SCALE 1:5

THESE BLOCKOUTS CAN BE USED TO RAISE W-BEAM RAIL HEIGHT ON EXISTING POSTS UP TO 180mm.

W BEAM ABRAHAM BLOCKOUT FOR RAISING RAIL HEIGHT ON EXISTING POSTS SCALE 1:5

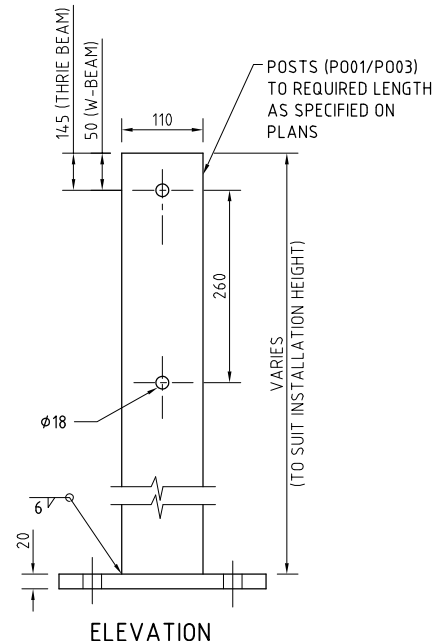

ELEVATION

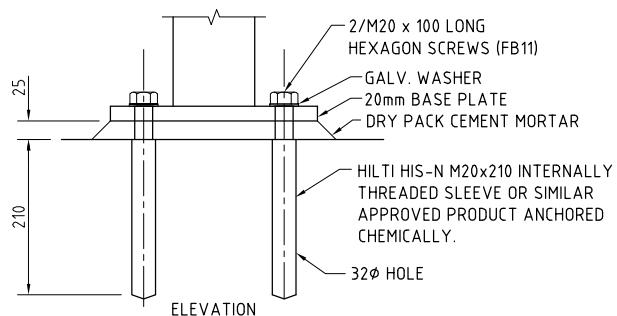

ELEVATION

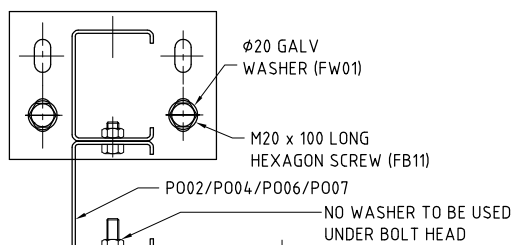

BASE PLATE INSTALLATION DETAIL

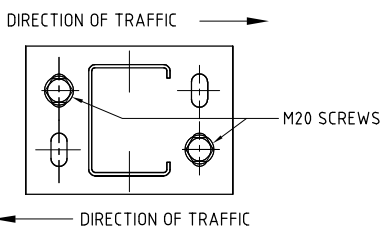

MEDIAN - BACK TO BACK SCREW CONFIGURATION

POST ON BASE PLATE SCALE 1:5

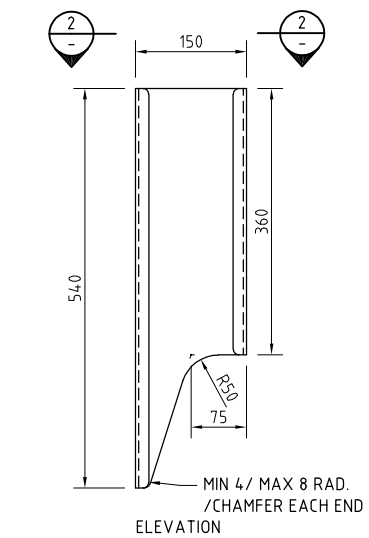

ABRAHAM BLOCKOUT OFFSIDE ONE-WAY TRAFFIC ONLY

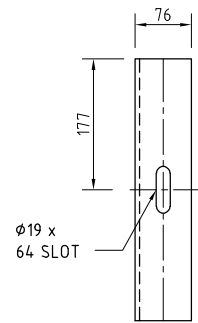

VIEW 6 SCALE 1:5

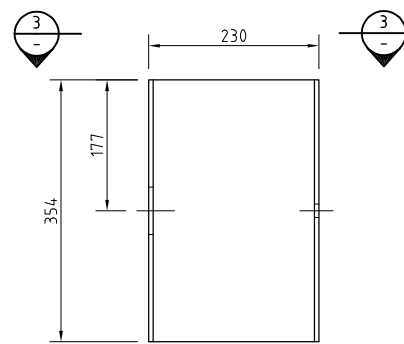

ELEVATION

VIEW 7 SCALE 1:5

FOR REPLACING TIMBER BLOCKOUTS ON EXISTING POSTS

W-BEAM G13 BLOCKOUT SCALE 1:5

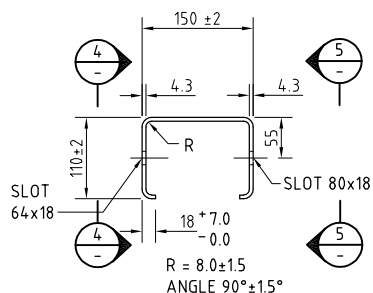

VIEW 1 SCALE 1:5

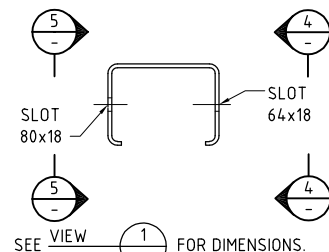

VIEW 2 SCALE 1:5

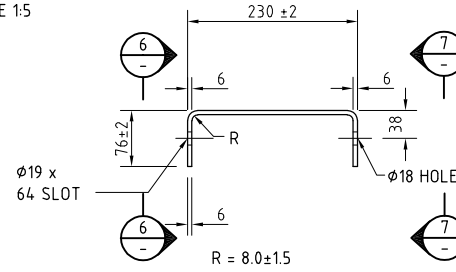

VIEW 3 SCALE 1:5

NOTES

- GENERAL**
- 1.0 POST AND BLOCKOUTS TO BE USED ONLY TO MAINTAIN EXISTING INSTALLATIONS
 - 1.1 THE MATERIAL USED FOR MOUNTING BRACKET MUST BE UV STABLE, RESISTANT TO HEAT, LOW TEMPERATURE, BENDING, TWISTING AND BREAKAGE DUE TO VEHICLE IMPACT.
 - 1.2 DELINEATORS SHALL MEET THE REQUIREMENTS OF AS 1742.2 TRAFFIC CONTROL DEVICES FOR GENERAL USE AND AS 1906.18.2 RETROREFLECTIVE MATERIALS AND DEVICES. WHERE SHEETING IS USED IT SHALL HAVE A MINIMUM DIMENSION OF 100mmx50mm ON A FLAT SURFACE FOR BOTH RED AND WHITE DELINEATORS.
 - 1.3 ON TWO-WAY CARRIAGEWAYS THE MOUNTING BRACKET SHALL HAVE RED AND WHITE RETROREFLECTORS ATTACHED ON THE OPPOSITE SIDES. ON ONE WAY CARRIAGEWAYS THE MOUNTING BRACKET SHALL HAVE RETROREFLECTOR ATTACHED TO ONE SIDE ONLY. A RED RETROREFLECTOR SHALL BE ATTACHED FOR NEARSIDE AND WHITE RETROREFLECTOR FOR OFFSIDE INSTALLATION.
 - 1.4 MOUNTING BRACKETS SHALL BE ATTACHED TO THE W/THRIE BEAM USING (FB03) M16 MUSHROOM HEAD SPLICE BOLTS WITH NUTS AND WASHER.
 - 1.5 OTHER APPROVED DELINEATION UNITS MAY BE USED.
 - 1.6 THE SPACING OF DELINEATORS ON THE GUARDFENCE IS DEPENDENT ON THE DISTANCE OF THE GUARDFENCE FROM THE NEAREST RUNNING LANE. IN THE ABSENCE OF NORMAL LINE OF GUIDE POSTS, OR FORMED TRAFFICABLE SHOULDER AT WHICH EDGE GUIDE POST WOULD TYPICALLY BE LOCATED, IT SHALL BE ASSUMED THAT THE NORMAL LOCATION OF GUIDE POSTS IS 2.0m FROM THE EDGE OF THE NEAREST RUNNING LANE. WHERE SECTION OF GUARDFENCE IS LOCATED:
 - (a) GREATER THAN 4.0m FROM THE EDGE OF THE NEAREST RUNNING LANE, DELINEATORS SHALL NOT BE INSTALLED ON THE GUARDFENCE.
 - (b) BETWEEN 4.0m FROM THE EDGE OF THE NEAREST RUNNING LANE AND THE NORMAL LINE OF GUIDE POSTS, DELINEATORS SHALL BE PLACED ON THE FIRST FENCE POST AND THEN THEIR SPACING TO BE AS CLOSE AS POSSIBLE TO THE SPACING SPECIFIED FOR GUIDE POSTS IN AS1742.2. SECTIONS OF GUARD FENCE LESS THAN 30M LONG SHALL ONLY HAVE ONE DELINEATOR AT EACH END OF THE FENCE.
 - (c) WITHIN THE NORMAL LINE OF GUIDE POSTS, DELINEATORS SHALL BE PLACED AT THE FIRST POST AND THEN AT A DESIRABLE SPACING OF 8.0m (BUT NOT GREATER THAN 10m).
 - 1.7 DELINEATORS SHALL NOT BE PLACED ON GUARDFENCE INSTALLED ALONGSIDE KERBED URBAN ROADS. THIS DOES NOT INCLUDE KERBS ON BRIDGES AND CULVERTS LOCATED ON ROADS, WHICH ARE PREDOMINANTLY UNKERBED.

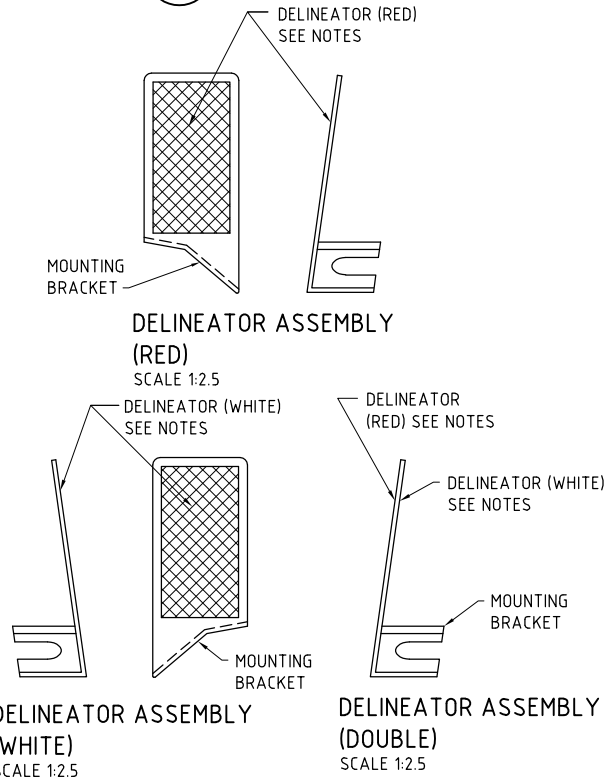

DELINEATOR ASSEMBLY (RED) SCALE 1:2.5

DELINEATOR ASSEMBLY (WHITE) SCALE 1:2.5

DESIGNED	
QUALIFICATION	
DATE:	DDMM/YYYY
REVIEWER	
QUALIFICATION	
DATE:	DDMM/YYYY
INDEPENDENT DESIGN CERTIFIER (IF REQUIRED)	
QUALIFICATION	
DATE:	DDMM/YYYY



Government of South Australia

Department for Infrastructure and Transport

STANDARD DRAWING
STEEL BEAM GUARDFENCE

POSTS, BLOCKOUTS & DELINEATORS

DESIGNED: A.P.	DRAFTED: DIT	ACCEPTED FOR USE: G.W. CHAPLIN	ACCEPTANCE FORM KNET No.:	DRAWING No.:	SHEET No.:	AMEND No.:
CHECKED: A.P.	REVIEWED: A.N.	DATE: 06/08/2004		S - 4050	45	3
			LATITUDE:		LONGITUDE:	

▲ TITLE BLOCK UPDATED AND NOTE ADDED	DU	PM	P MOLLOY	27/05/21	
▲ IDENTIFIER ADDED	AP	PD	G W CHAPLIN	4/8/05	
▲ SUPERSEDE NOTE ADDED	AP	PD	G W CHAPLIN	27/6/05	
No.	AMENDMENT DESCRIPTION	BY	CHECK	ACCEPTANCE	DATE

▲ SUPERSEDES DRG S-4050 SHEETS 29-35

100 MILLIMETRES ON ORIGINAL A1 DRAWING ALL DIMENSIONS ARE IN MILLIMETRES UNLESS SHOWN OTHERWISE UNCONTROLLED COPY WHEN PRINTED